

PLAN
SCALE 1:500

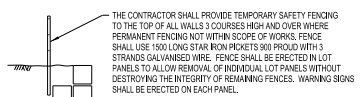

TEMPORARY RETAINING WALL FENCES FOR WALLS GREATER THAN 2 VISIBLE COURSES.
(DIAGRAMATIC)

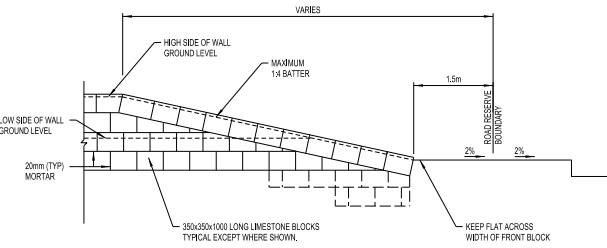

TYPICAL WALL ELEVATION
SCALE 1:50

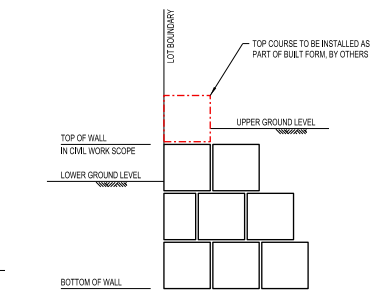

SECTION A - TYPICAL RETAINING WALL DETAIL
SCALE 1:20

LEGEND:

- STAGE BOUNDARY
- - - EXISTING RETAINING WALL
- - - FUTURE RETAINING WALL
- - - PROPOSED LIMESTONE RETAINING WALL
- (74.43.30) TOP OF FINISHED RETAINING WALL HEIGHT TOP COURSE TO BE INSTALLED AS PART OF BUILT FORM BY OTHERS
- (74.40.1) TOP OF RETAINING WALL HEIGHT IN CIVIL WORK SCOPE
- (74.36.52) BOTTOM OF RETAINING WALL HEIGHT
- (74.02.08) EXISTING PAD LEVEL
- (74.02.08) EXISTING STAIRS
- (74.02.08) PROPOSED STAIRS

I HEREBY CERTIFY THAT THESE WALLS HAVE BEEN DESIGNED TO ACCOMMODATE THE DESIGN LOAD PARAMETERS AS INDICATED IN THE TABLE ABOVE.

(PRINT NAME)

PRACTISING STRUCTURAL ENGINEER FOR WOOD AND GREVE ENGINEERS

Copyright Reserved

Colour Disclaimer

The drawing has been documented in colour. The drawing is required to be printed in colour. It is not to be used as a reference for colour information. Black and white printing may be used if specific black and white documents have been obtained from Stantec.

Notes

1. LIMESTONE BLOCKS SHALL HAVE A MINIMUM DRY DENSITY OF 1800 KG/M³.
2. ALL LIMESTONE BLOCKS TO BE TUNGSTEN CUT AND PALLETISED.
3. ALL LIMESTONE BLOCKS TO BE FULLY JOINTED WITH MORTAR (MINIMUM 1:2.9 CEMENT:LIME:SAND RATIO).
4. MORTAR JOINTS TO BE 20mm WIDE. FINISHED FLUSH WITH A RULED JOINT TOP COURSE OF WALL TO HAVE FLUSH JOINTS ON TOP SURFACE ONLY.
5. COMPACTED SAND BACKFILL TO WALLS IN 300mm LAYERS TO NOT LESS THAN 95% MDD TO A1500 E2.1.
6. FACE BLOCKS SHALL BE RECONSTITUTED LIMESTONE AND SELECTED ON SITE TO ENSURE THAT ONLY CLEAN SQUARE EDGES FREE FROM MAJOR CHIPS ARE VISIBLE IN TOP COURSE AND FACEWORK.
7. WALL TO BE FULLY PROPPED PRIOR TO BACKFILL AND COMPACTON.
8. COMPACT GROUND IN FRONT OF WALL PRIOR TO BACKFILL AND COMPACTON.
9. ALL BACKFILL TO BE FREE DRAINING CLEAN SAND, FREE OF DELETERIOUS MATTER.
10. FOOTING SUBGRADE TO BE COMPACTED TO 95% MDD BEFORE LAYING LIMESTONE BLOCK.
11. CONTRACTOR SHALL CONFIRM FINISHED VERGE LEVEL BEFORE COMMENCING RETAINING WALL CONSTRUCTION ADJACENT TO VERGES.
12. RETAINING WALL SETOUT DRAWING TO BE READ IN CONJUNCTION WITH DRAWINGS 27542-PRC-LEVEL EA, EB, AND EC.
13. CONTRACTOR TO PROVIDE CONSTRUCTION JOINT CONNECTION TO EXISTING WALL.
14. RIBBLE SHALL NOT BE USED TO FILL VOIDS UNLESS OTHERWISE NOTED. RECONSTITUTED BLOCKS SHALL BE USED FOR PACING BLOCKS. ALL BLOCKS SHALL BE LAYED IN ACCORDANCE WITH DETAIL ON DRAWING 27542-PRC-C076.
15. NONSACRIFICIAL ANTI-GRAFFITI COATING SHALL BE APPLIED TO ANY WALLS EXPOSED TO ROAD FRONTAGE, P.O.S. OR SCHOOLS. CONTRACTOR SHALL PROVIDE CERTIFICATE THAT COATING HAS BEEN APPLIED AND BESE CLEANING SPECIFICATION TO SUPERINTENDANT FOR LODGEMENT WITH COUNCIL PRIOR TO PRACTICAL COMPLETION.
16. ALL RETAINING WALL STUBS EXTENDING INTO FUTURE LOTS ARE TO BE 2m LONG.

ORIGINAL ISSUE	A	KLL	DANT	2022.03.30
Revision	Rev	By	Appd	YYYY.MM.DD

File Name: C:PLAN RETAINING WALLS.DGN	KLL	KLL	DANT	2022.03.01
Dwn	Dwn	Dwn	Chkd	YYYY.MM.DD

Issue Status

PRELIMINARY
NOT FOR CONSTRUCTION

This document is suitable only for the purpose noted above. Use of this document for any other purpose is not permitted.

Client/Project Logo

Client/Project
YOLK PROPERTY GROUP

KARDINYA STAGE 3 CLOSE-OUT WORKS

LOT 4225 NORTH LAKE ROAD, KARDINYA

Title
RETAINING WALL PLAN

Project No.	WAPC No.	Scale
27542	248-16	1:500 @ A1
Revision	Drawing No.	PER-C-3-E11
A		

Stantec Australia Pty. Ltd.
Level 1 The Terrace Centre
94-102 Stirling Terrace
Albany, WA 6330
Tel: +61 8 9842 3700

Copyright Reserved

The Contractor shall verify and be responsible for all dimensions. DO NOT scale the drawing - any errors or omissions shall be reported to Stantec without delay. The Copyrights to all designs and drawings are the property of Stantec. Reproduction or use for any purpose other than that authorized by Stantec is prohibited.

Colour Disclaimer

This drawing has been documented in colour. This drawing is required to be printed in colour. Failure to do so may result in loss of information. Black and white printing may be used if specific black and white documents have been obtained from Stantec.

Notes

1. THIS DRAWING IS TO BE READ IN CONJUNCTION WITH ALL 27542-PER-C-3 DRAWINGS, STAGEWORKS1 AND SPECIFICATION.
2. ALL FENCE POSTS TO BE CORED MINIMUM 25mm INTO THE THIRD COURSE.

LEGEND

- EXISTING RETAINING WALL
- PROPOSED CANTILEVER WALL
- FENCE LONGSECTIONS REFERENCE NAME, (REFER TO FENCE LONGSECTIONS)
- FE 1 PROPOSED PIER AND INFILL FENCING FENCE 4 - FENCE SPOT CLASSIC (OR SIMILAR APPROVED BY SUPERINTENDENT) COLOUR: BLACK
- PROPOSED MASONRY ACOUSTIC WALL
- PROPOSED 1.8m HIGH FENCE SPOT CLASSIC FENCE COLOUR: BLACK
- PROPOSED 1.8m HIGH COLOURBOND FENCE COLOUR: SURFIMAT
- PROPOSED 450x350 BAG RENDERED AND PAINTED PIER
- PROPOSED 400 x 400 MIDLAND BRICK FLORENTINE LIMESTONE PIER
- PROPOSED 350 x 350 MASONRY PIER
- EXISTING STAIRS
- PROPOSED STAIRS
- PROPOSED PEDESTRIAN GATE
- Ⓢ START OF FENCE LONGSECTION
- Ⓤ END OF FENCE LONGSECTION

AMENDED WHERE CLOUDED	D	KLI	DMN	2022.04.07
FENCE LONG SECTION NUMBER ADDED AND AMENDED WHERE CLOUDED	C	KLI	DMN	2022.04.01
AMENDED WHERE CLOUDED	B	KLI	DMN	2022.03.15
ORIGINAL ISSUE	A	KLI	DMN	2022.03.01
Revision	Rev	By	App'd	YYYY.MM.DD
File Name: C:\PLAN\FENCING.DGN	KLI	KLI	DMN	2022.03.01
	Drawn	Diagn	Chkd	YYYY.MM.DD

Issue Status

PRELIMINARY
NOT FOR CONSTRUCTION

This document is suitable only for the purpose noted above. Use of this document for any other purpose is not permitted.

Client/Project Logo

Client/Project
YOLK PROPERTY GROUP

KARDINYA STAGE 3 CLOSE-OUT WORKS

LOT 4225 NORTH LAKE ROAD, KARDINYA

Title
FENCING PLAN

Project No.	WAPC No.	Scale
27542	248-16	1:250 @ A1
Revision	Drawing No.	
D	PER-C-3-FE1	

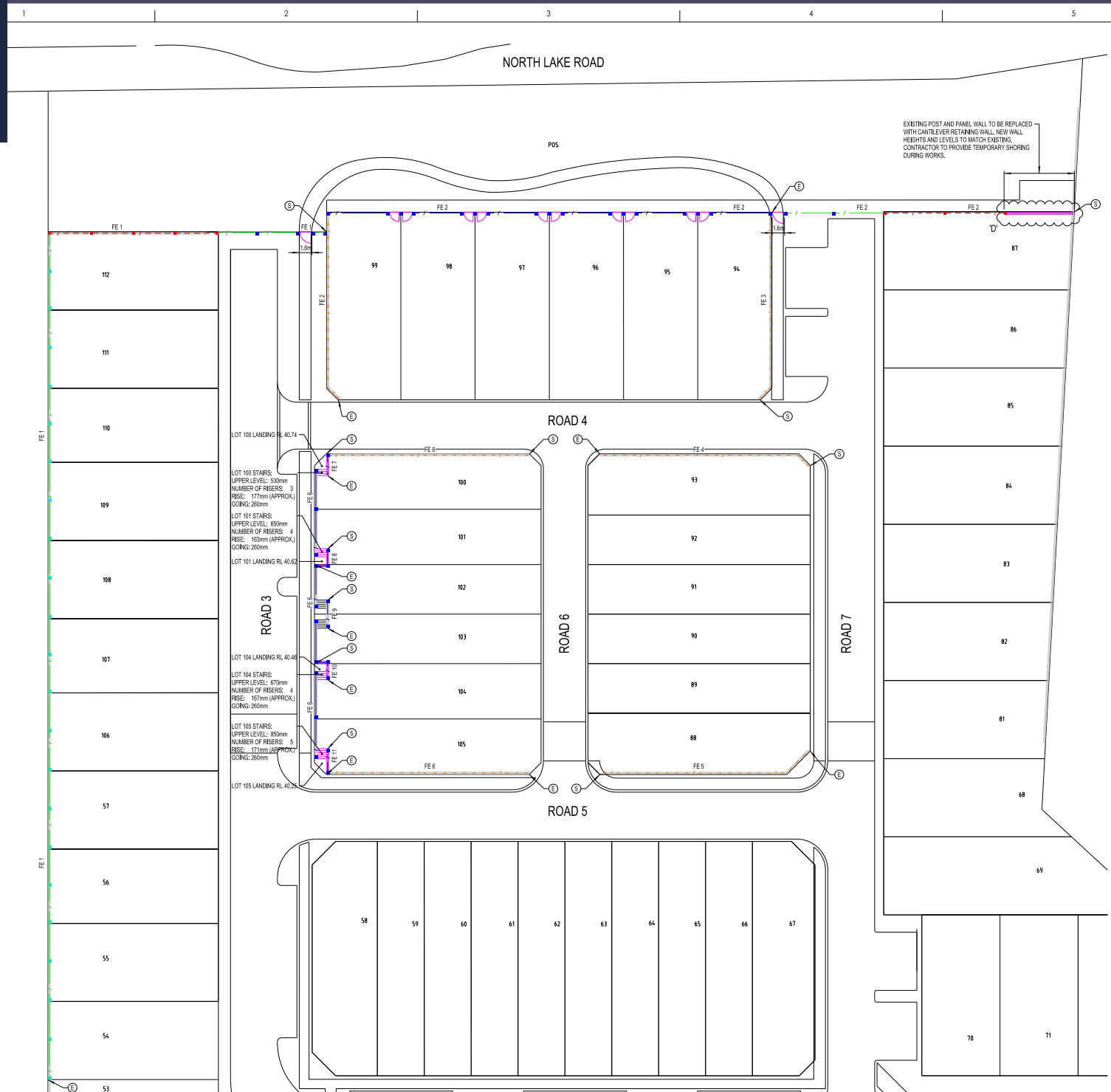

FENCING PLAN
SCALE 1:250

Stantec Australia Pty. Ltd.
Level 1 The Terrace Centre
96-102 Shilling Terrace
Albany, WA 6330
Tel: +61 8 9842 3700

Copyright Reserved

The Contractor shall verify and be responsible for all dimensions. DO NOT locate the drawings on any eraser or correction fluid as reported to Stantec without delay. The Copyright to all designs and drawings are the property of Stantec. Reproduction or use for any purpose other than that authorized by Stantec is forbidden.

Colour Disclaimer

The drawing has been documented in colour. The drawing is required to be printed in colour. Failure to do so may result in loss of information. Black and white printing may be used in black and white documents have been obtained from Stantec.

Notes

- THIS DRAWING IS TO BE READ IN CONJUNCTION WITH DRAWING 27542-PER-C-01-EX STD-WG51(D), 27542-PER-C-1(FE) AND SPECIFICATION.
- WHERE FOOTINGS RESTRICTED BY BOUNDARIES/TRUNCATIONS, FOOTING SHAPE TO BE AMENDED TO SUIT BOUNDARY. REFER TO TRUNCATION DETAILS.
- NO PORTION OF FOOTING TO ENCRoACH INTO ROAD RESERVE.
- WHERE PIERS PRESENT, RETAINING WALL FOOTINGS TO BE AMENDED TO SUIT THE PIER FOOTING. REFER TO PIER DETAILS.

MASONRY NOTES

- MASONRY CLADDING TO CONSIST OF 305 x 150mm BRICKS, CUT TO SUIT AS NECESSARY.
- ALL MASONRY TO BE BONDED WITH MORTAR CLASS AS FOLLOWS UNL/D:
M3 CLASS MORTAR (1 CEMENT:1 LIM:6 SAND)
- MIN. UNCONFINED COMPRESSIVE STRENGTHS OF MASONRY TO BE AS FOLLOWS:
BRICKWORK: 12MPa
- THE MASONRY TO WALL WITH APPROVED PROPRIETARY TIES AT 500mm MAX. CRS VERTICALLY AND 1000mm MAX. CRS HORIZONTALLY (WHERE APPLICABLE). VERTICAL CRS MAY BE INCREASED TO 400mm IN THE CASE OF BLOCKWORK UNL/D. TOP ROW OF TILES TO BE INSTALLED UNDER TOP ROW OF MASONRY CLADDING.
- ALL BED JOINTS AND PERPS TO BE FULLY BEDDED MORTAR.
- MAXIMUM VERTICAL WALL JOINT SPACING TO COMPLY WITH THE FOLLOWING UNL/D. REFER TO ARCHITECTURAL DRAWINGS FOR EXACT LOCATIONS):

SITE CLASS	WALL CONSTRUCTION	JOINT SPACING (m)
A & S	ALL	8.0

- JOINTS ARE TO BE 10mm BRIDGED WITH MFAS AT 300 CRS (MAX) AND FILLED WITH A COMPRESSIBLE MASTIC SEALANT ON A BACKING ROD.
- VERTICAL CHASING IS ACCEPTABLE WITHIN INTERNAL WALLS ONLY. MAXIMUM DEPTH OF VERTICAL CHASING IS 20mm AND TO ONLY BE LOCATED ON ONE FACE.
- DESIGN APPLICABLE ONLY FOR WIND REGION A1.

AMENDED WHERE CLOUDED	B	KLI	DMN	2022.04.01
ORIGINAL ISSUE	A	KLI	DMN	2022.03.01
Revision	Rev	By	Appr	YYYY.MM.DD

No	Name	C	KLI	KLI	DMN	2022.03.01
		Own	Dist	Chkd	YYYY.MM.DD	

Issue Status

**PRELIMINARY
NOT FOR CONSTRUCTION**

This document is suitable only for the purpose noted above. Use of this document for any other purpose is not permitted.

Client/Project Logo

Client/Project
YOLK PROPERTY GROUP

KARDINYA STAGE 3 CLOSE-OUT WORKS

LOT 4225 NORTH LAKE ROAD, KARDINYA

Title
FENCING AND PIER DETAILS
SHEET 1 OF 2

Project No.	WAPC No.	Scale
27542	248-16	AS SHOWN
Revision	Drawing No.	PER-C-3-FE2

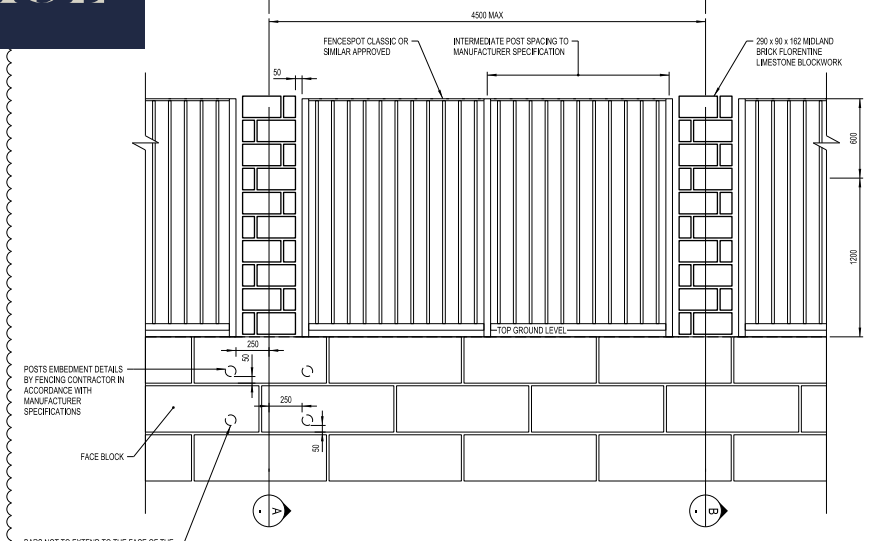

FENCESPOT FENCING ON RETAINING WALL DETAIL
SCALE 1:20

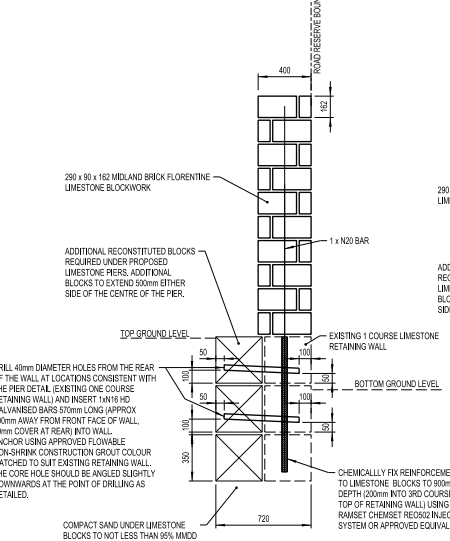

SECTION A-A
SCALE 1:20

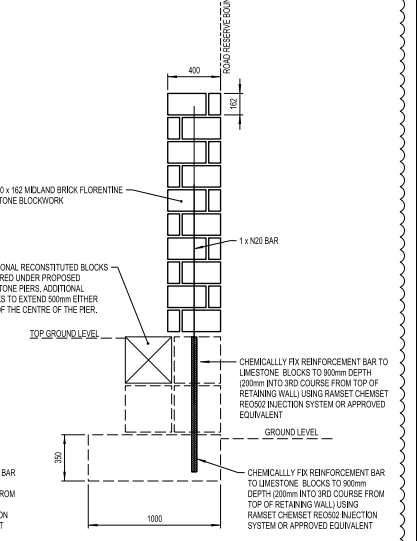

SECTION B-B
SCALE 1:20

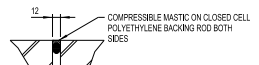

BRICK CONTROL JOINT (B.C.J.)
N.T.S.

HEREBY CERTIFY THAT THESE WALLS HAVE BEEN DESIGNED TO ACCOMMODATE THE DESIGN LOAD PARAMETERS AS INDICATED IN THE TABLE ABOVE.

(PRINT NAME)

PRACTISING STRUCTURAL ENGINEER FOR WOOD AND GREVE ENGINEERS

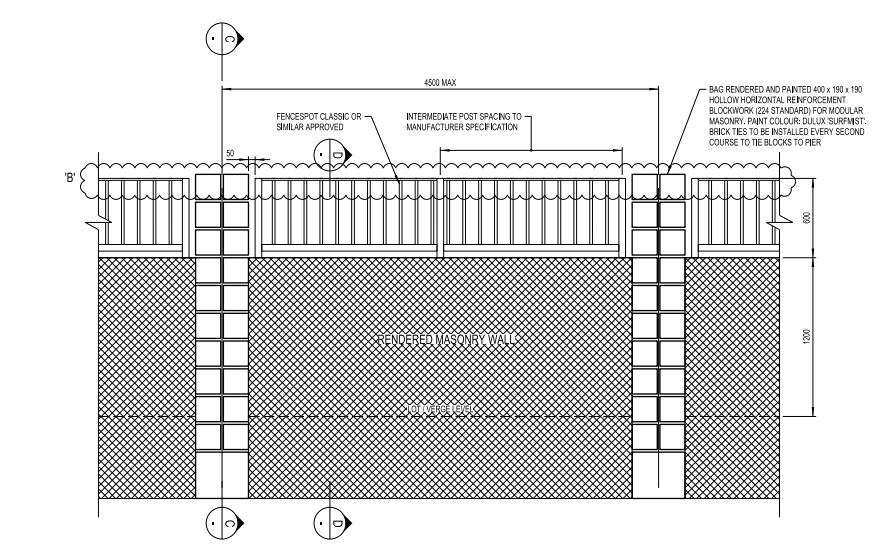

PIER AND INFILL FENCING ON MASONRY WALL DETAIL
SCALE 1:20

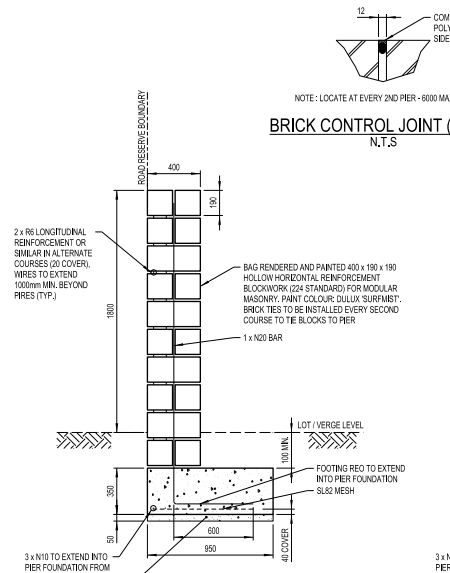

SECTION C-C
SCALE 1:20

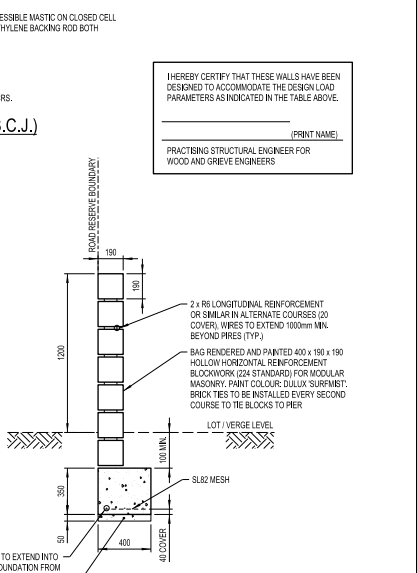

SECTION D-D
SCALE 1:20

HEREBY CERTIFY THAT THESE WALLS HAVE BEEN DESIGNED TO ACCOMMODATE THE DESIGN LOAD PARAMETERS AS INDICATED IN THE TABLE ABOVE.

(PRINT NAME)

PRACTISING STRUCTURAL ENGINEER FOR WOOD AND GREYE ENGINEERS

AMENDED WHERE CLOUDED	E	KLI	DMN	2022.06.10
AMENDED WHERE CLOUDED	D	KLI	DMN	2022.04.11
AMENDED WHERE CLOUDED	C	KLI	DMN	2022.04.01
AMENDED WHERE CLOUDED	B	KLI	DMN	2022.03.16
ORIGINAL ISSUE	A	KLI	DMN	2022.03.01
Revision	Rev	By	App'd	YYYY.MM.DD
File Name: C:\PLAN FENCING.DGN	KLI	KLI	DMN	2022.03.01
	Dwn.	Dgn.	Chkd.	YYYY.MM.DD

Issue Status

PRELIMINARY
NOT FOR CONSTRUCTION

This document is suitable only for the purpose noted above. Use of this document for any other purpose is not permitted.

Client/Project Logo

Client/Project
YOLK PROPERTY GROUP

KARDINYA STAGE 3 CLOSE-OUT WORKS

LOT 4225 NORTH LAKE ROAD, KARDINYA

Title
FENCING AND PIER DETAILS
SHEET 2 OF 2

Project No.	WAPC No.	Scale
27542	248-16	AS SHOWN
Revision	Drawing No.	PER-C-3-FE3
E		

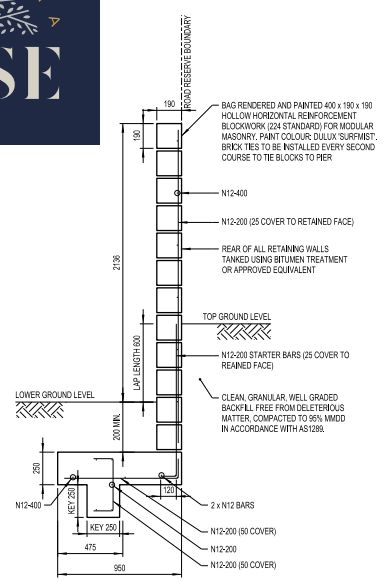

TYPICAL CANTILEVER WALL DETAIL
SCALE 1:20

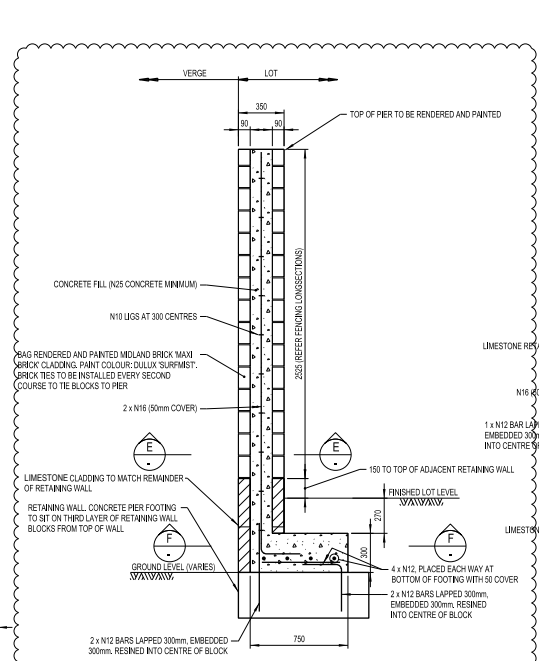

450 x 350 BAG RENDERED MASONRY PIER ON LIMESTONE WALL
SCALE 1:20

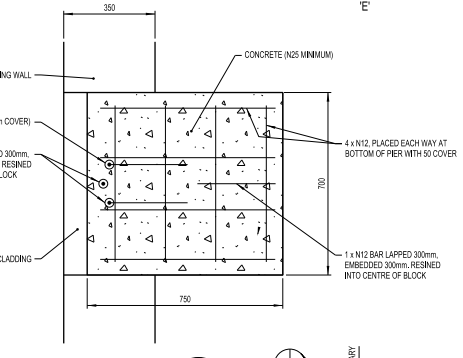
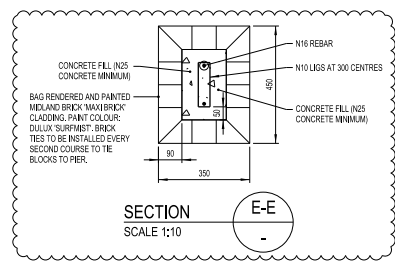

SECTION F-F
SCALE 1:10

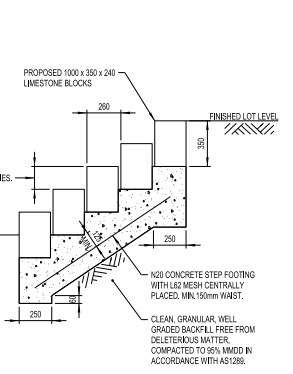

TYPICAL STAIRCASE DETAIL
SCALE 1:20

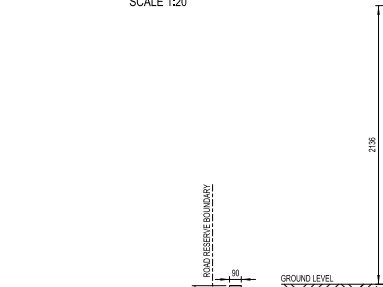

TYPICAL MASONRY ACOUSTIC WALL DETAIL
SCALE 1:20

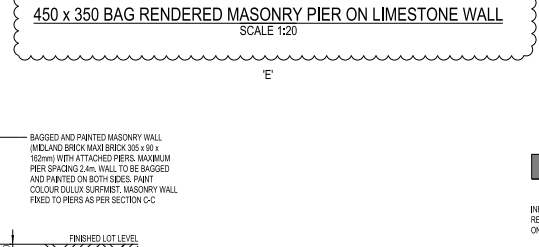

2.1m MASONRY PIER DETAIL
SCALE 1:20

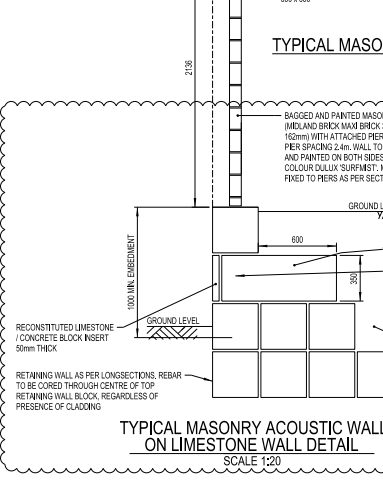

TYPICAL MASONRY ACOUSTIC WALL ON LIMESTONE WALL DETAIL
SCALE 1:20

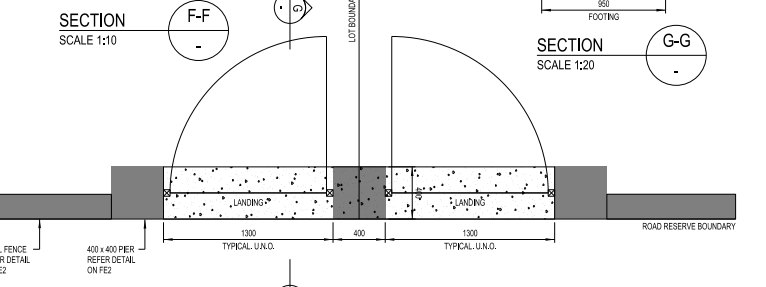

PLAN VIEW
SCALE 1:20

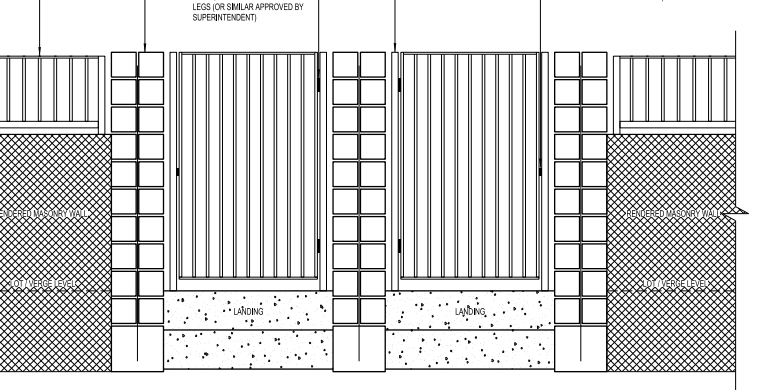

ELEVATION VIEW
SCALE 1:20



PEDESTRIAN GATE DETAIL
SCALE 1:20

D

C

B

A



Stantec Australia Pty. Ltd.
Level 1 The Terrace Centre
96-102 Stirling Terrace
Albany WA 6330
Tel: +61 8 9642 3700

Copyright Reserved

The Contractor shall verify and be responsible for all dimensions. DO NOT scale the drawings - any errors or omissions will be reported to Stantec without delay. The Copyrights to all design and drawings are the property of Stantec. Reproduction or use for any purpose other than that authorized by Stantec is forbidden.

Colour Disclaimer
The drawing has been documented in colour. The drawings required to be printed in colour. Failure to do so may result in loss of information. Black and white printing may be used if specific black and white documents have been obtained from Stantec.

Notes

- THE DRAWING IS TO BE READ IN CONJUNCTION WITH ALL 27542-PER-C-3 DRAWINGS, SITEWESETT AND SPECIFICATION.

LEGEND

- EXISTING LIMESTONE RETAINING WALL
- PROPOSED CANTILEVER RETAINING WALL
- PROPOSED PIER AND INFILL FENCING ON MASONRY WALL
- PROPOSED MASONRY ACOUSTIC WALL
- PROPOSED 1.8m HIGH FENCEPOST CLASSIC FENCE
- PROPOSED 1.8m HIGH COLOURBOND FENCE
- PROPOSED 400 x 400 BAG RENDERED AND PAINTED PIER
- PROPOSED 400 x 400 MIDLAND BRICK FLORENTINE LIMESTONE PIER
- PROPOSED 300 x 300 CONCRETE FOOTING
- PROPOSED PEDESTRIAN GATE

AMENDED WHERE CLOUSED	B	KLI	DMN	2022.04.07	
ORIGINAL ISSUE	A	KLI	DMN	2022.04.07	
Revision		Rev	By	App'd	YYYY.MM.DD
Title Name: C PLAN FENCING.DGN		KLI	KLI	DMN	2022.03.01
		Dwn	Dgn	Chkd	YYYY.MM.DD

Issue Status

PRELIMINARY
NOT FOR CONSTRUCTION

This document is suitable only for the purpose noted above. Use of this document for any other purpose is not permitted.

Client/Project Logo

Client/Project
YOLK PROPERTY GROUP

KARDINYA STAGE 3 CLOSE-OUT WORKS

LOT 4225 NORTH LAKE ROAD, KARDINYA

Title
FENCING LONG SECTIONS
SHEET 1 OF 2

Project No.	WAPC No.	Scale
27542	248-16	AS SHOWN
Revision	Drawing No.	
B	PER-C-3-FE4	

D

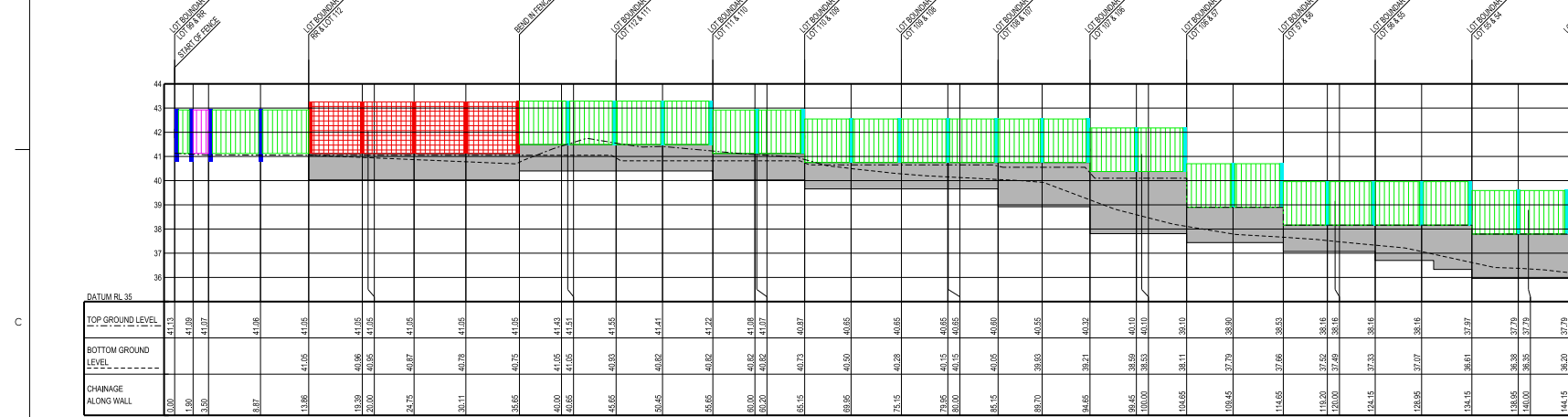

FENCING LONGSECTION 1 (FE 1)
SCALE 1:250 H
1:100 V

B

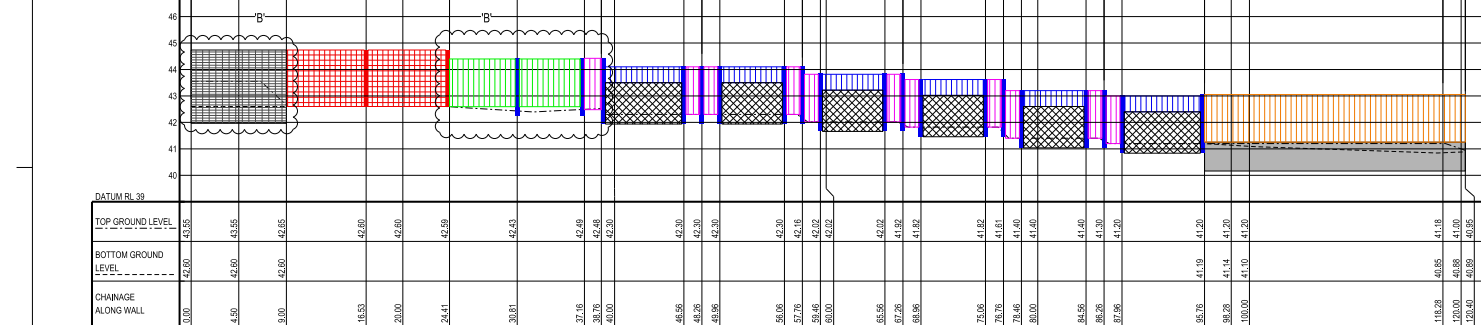

FENCING LONGSECTION 2 (FE 2)
SCALE 1:250 H
1:100 V

A

LEGEND

- RETAINING WALL
- PROPOSED PIER AND INFILL FENCING ON MASONRY WALL
- PROPOSED MASONRY ACOUSTIC WALL
- PROPOSED 1.8m HIGH FENCESPOT CLASSIC FENCE
- PROPOSED 1.8m HIGH COLOURBOND FENCE
- PROPOSED 400 x 400 BAG RENDERED AND PAINTED PIER
- PROPOSED 400 x 400 MIDLAND BRICK FLORENTINE LIMESTONE PIER
- PROPOSED 350 x 350 CONCRETE FOOTING
- PROPOSED PEDESTRIAN GATE

ORIGINAL ISSUE	A	KIL	DMN	2022.04.01
Revision	Rev	By	Appd	YYYY.MM.DD
File Name: C PLAN FENCING.DGN	KIL	KIL	DMN	2022.03.01
	Desn	Disgn	Chkd	YYYY.MM.DD

Issue Status

PRELIMINARY
NOT FOR CONSTRUCTION

This document is suitable only for the purpose noted above. Use of this document for any other purpose is not permitted.

Client/Project Logo

Client/Project
YOLK PROPERTY GROUP

KARDINYA STAGE 3 CLOSE-OUT WORKS

LOT 4225 NORTH LAKE ROAD, KARDINYA

Title
FENCING LONG SECTIONS
SHEET 2 OF 2

Project No.	WAPC No.	Scale
27542	248-16	AS SHOWN
Revision	Drawing No.	PER-C-3-FE5

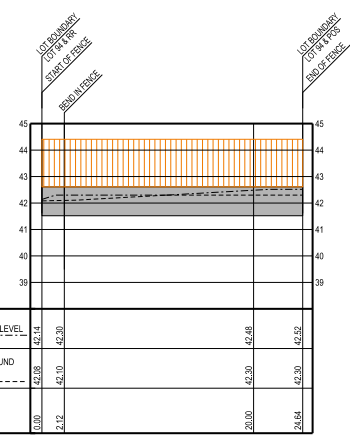

FENCING LONGSECTION 3 (FE 3)
SCALE 1:250 H
1:100 V

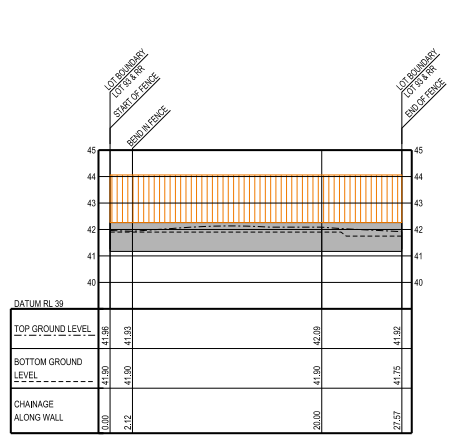

FENCING LONGSECTION 4 (FE 4)
SCALE 1:250 H
1:100 V

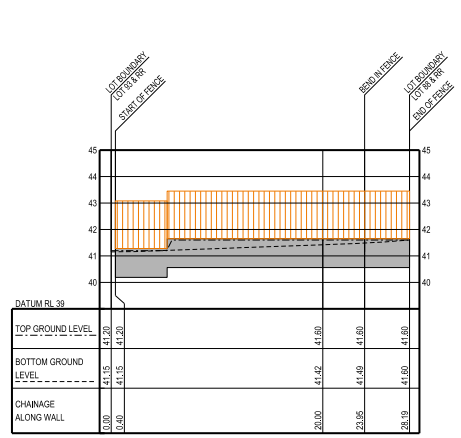

FENCING LONGSECTION 5 (FE 5)
SCALE 1:250 H
1:100 V

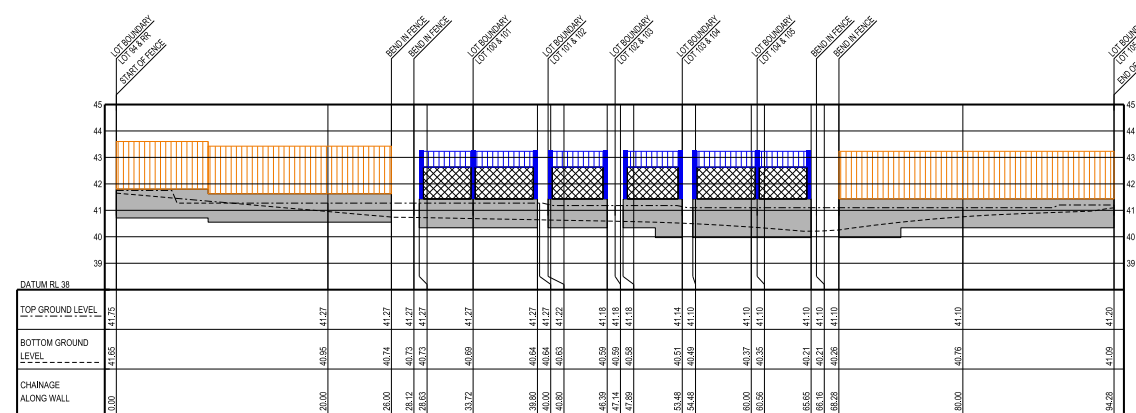

FENCING LONGSECTION 6 (FE 6)
SCALE 1:250 H
1:100 V

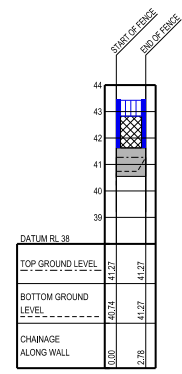

FENCING LONGSECTION 7 (FE 7)
SCALE 1:250 H
1:100 V

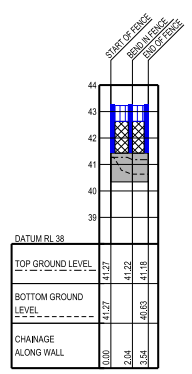

FENCING LONGSECTION 8 (FE 8)
SCALE 1:250 H
1:100 V

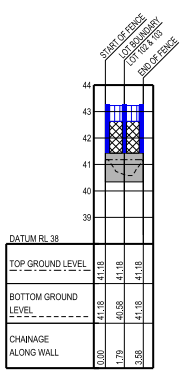

FENCING LONGSECTION 9 (FE 9)
SCALE 1:250 H
1:100 V

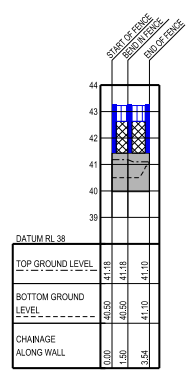

FENCING LONGSECTION 10 (FE 10)
SCALE 1:250 H
1:100 V

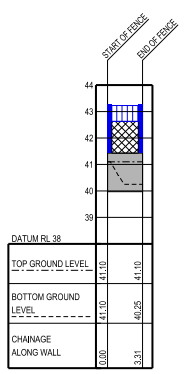

FENCING LONGSECTION 11 (FE 11)
SCALE 1:250 H
1:100 V

D
C
B
A